



## TYPE G: 75 through 1,200 Amperes

### TYPE G: 50 mV

Catalog Number	AMP	A	B	C	D	E	F
G-75-50	75	6	1.06	4.50	0.12	0.41	2.5
G-80-50	80	6	1.13	4.50	0.12	0.41	2.5
G-100-50	100	6	1.41	4.50	0.12	0.41	2.5
G-150-50	150	6	1.06	4.50	0.18	0.53	2.5
G-200-50	200	6	1.41	4.50	0.18	0.53	2.5
G-250-50	250	6	1.18	4.50	0.31	0.53	2.5
G-300-50	300	6	1.41	4.50	0.31	0.53	2.5
G-400-50	400	6	1.41	4.50	0.38	0.53	2.5
G-500-50	500	6	1.77	4.50	0.38	0.53	2.5
G-600-50	600	8	2.12	6	0.50	0.66	2.5
G-800-50	800	8	2.26	6	0.50	0.66	2.5
G-1000-50	1000	8	2.83	6	0.50	0.66	2.5
G-1200-50	1200	8	2.83	6	0.50	0.66	2.5

### TYPE G: 100 mV

Catalog Number	AMP	A	B	C	D	E	F
G-75-100	75	8	1.06	6.50	0.12	0.41	4.5
G-80-100	80	8	1.13	6.50	0.12	0.41	4.5
G-100-100	100	8	1.41	6.50	0.12	0.41	4.5
G-150-100	150	8	1.06	6.50	0.18	0.53	4.5
G-200-100	200	8	1.41	6.50	0.18	0.53	4.5
G-250-100	250	8	1.18	6.50	0.31	0.53	4.5
G-300-100	300	8	1.41	6.50	0.31	0.53	4.5
G-400-100	400	8	1.41	6.50	0.38	0.53	4.5
G-500-100	500	8	1.77	6.50	0.38	0.53	4.5
G-600-100	600	10	2.12	8	0.50	0.66	4.5
G-800-100	800	10	2.26	8	0.50	0.66	4.5
G-1000-100	1000	10	2.83	8	0.50	0.66	4.5
G-1200-100	1200	10	2.83	8	0.50	0.66	4.5

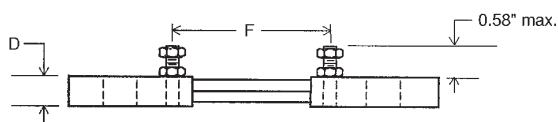
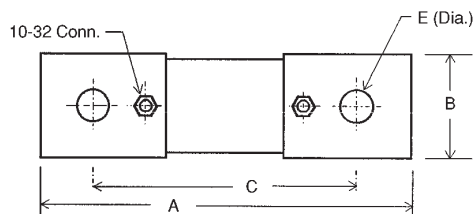
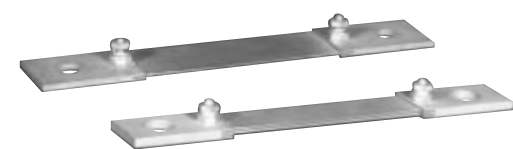

## TYPE G: 1,500 through 2,500 Amperes



### TYPE G: 50 mV

Catalog Number	AMP	A	B	C	D	E	F	G
G-1500-50	1500	8	3.02	6	0.62	1.75	0.88	2.50
G-2000-50	2000	8	4.04	6	0.62	2.50	1.25	2.50
G-2500-50	2500	8	3.92	6	0.75	2.50	1.25	2.50

### TYPE G: 100 mV

Catalog Number	AMP	A	B	C	D	E	F	G
G-1500-100	1500	10	3.02	8	0.625	1.75	0.88	4.50
G-2000-100	2000	10	4.04	8	0.625	2.50	1.25	4.50
G-2500-100	2500	10	3.92	8	0.750	2.50	1.25	4.50

